



Lake County Green 2015 Green Infrastructure Sustainable Facility Planning

Date: May 27, 2015
Presented by: James J. Mladucky AIA, ACHA, CCS
Director Facility Planning & Construction
Northwestern Memorial HealthCare

We aspire to be the *destination* of choice for people seeking *quality* healthcare and for those who provide, support and advance that care through *leading-edge* treatments and *breakthrough* discoveries. Our shared *commitment to transform* healthcare and to be among the nation's *top 10* academic medical centers will be accomplished through *innovation and excellence.*

Our Shared Mission...

Patient's First



We are transforming healthcare to be a top academic health system known for quality and excellence.



We have an essential relationship with Northwestern University Feinberg School of Medicine.



We are an integrated academic health system where the patient comes first.

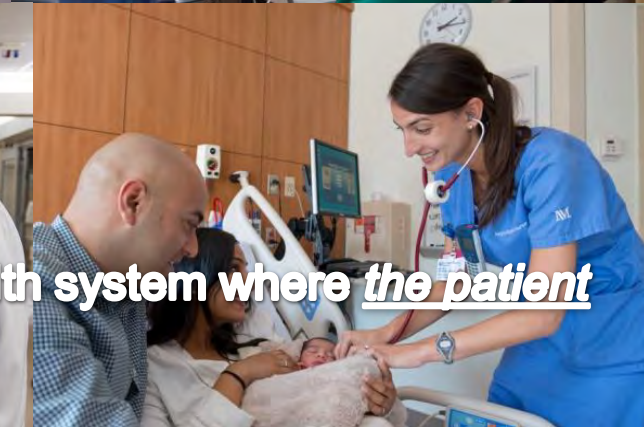

Northwestern Medicine...

Make no little plans

NU Campus Established 1928
13.5 Million SF on 35 Acres
Northwestern Memorial Hospital
Controls 5.5 Million SF
873 Inpatient Beds
1 Million Annual Outpatient Visits



Sustainability – Corporate / Social Responsibility

Northwestern Medicine

- Fulfill social and fiscal corporate responsible
- Sustainability is one of NM staff and patients top concerns
- Reduce NM Carbon Footprint
- Opportunity to move toward self-reliance
- Northwestern Medicine is already a leader in sustainable design and construction

Northwestern Medicine

Sustainable Construct

Organized into three areas: 1) *Campus Environments* – facilities design, construction and maintenance; 2) *Administration & Oversight* – corporate goals, policy and measurement, and; 3) *Personal Subsistence* – NM staff education, personal involvement and celebrations around *achievement and esults*.

Campus Environments

- **Aim:** Facility and site performance standards for all NMHC projects including LEED , ASHREA 189.1, EnergyStar to assure NM Facilities meet the standard throughout the system
- **Course:** Provide a process roadmap for ensuring sustainability is addressed at key points during the planning, design, construction, activation and facility maintenance phases of our buildings.
- **Opportunity:** Provide a manual of best practices and guidance for project teams to consider including benefit analysis, ROI, life-cycle analysis of systems and processes to move NM toward carbon neutral.



- Sustainable Sites
- Water Efficiency
- Energy & Atmosphere
- Materials & Resources
- Indoor Environmental Quality
- Innovation & Design Process



First LEED Silver Hospital in Illinois

Prentice Woman's Hospital



New Replacement Hospital
1 million SF
224 Beds
86 Bassinets Level 3 / NICU
Opened October 2007

LEED Silver

Galter Pavilion – 9, 10 & 13 Bed Expansion



3 – Floors / Renovation
120,000 SF
48 ICU / Medical Surgical and
12 Observation Beds
29 Behavioral Health
Opened September 2011



LEED Silver

Outpatient Care 259 Pavilion

24 stories
993,000 SF
Physician Offices, Outpatient
Surgery & Radiology Imaging
Center
Opened October 2014



View from Fairbanks - North

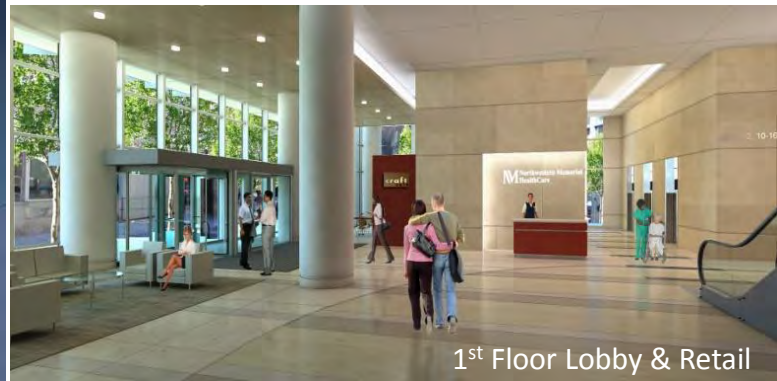

1st Floor Lobby & Retail



Ontario Retail Corner



Erie Street Entrance

LEED Silver / Geothermal Heating & Cooling System

Bernice E. Lavin Early Childhood Education Center

2 – Level Daycare
1,147 Car Garage
300 plus Student
Largest Daycare in Chicago
Opened June 2012

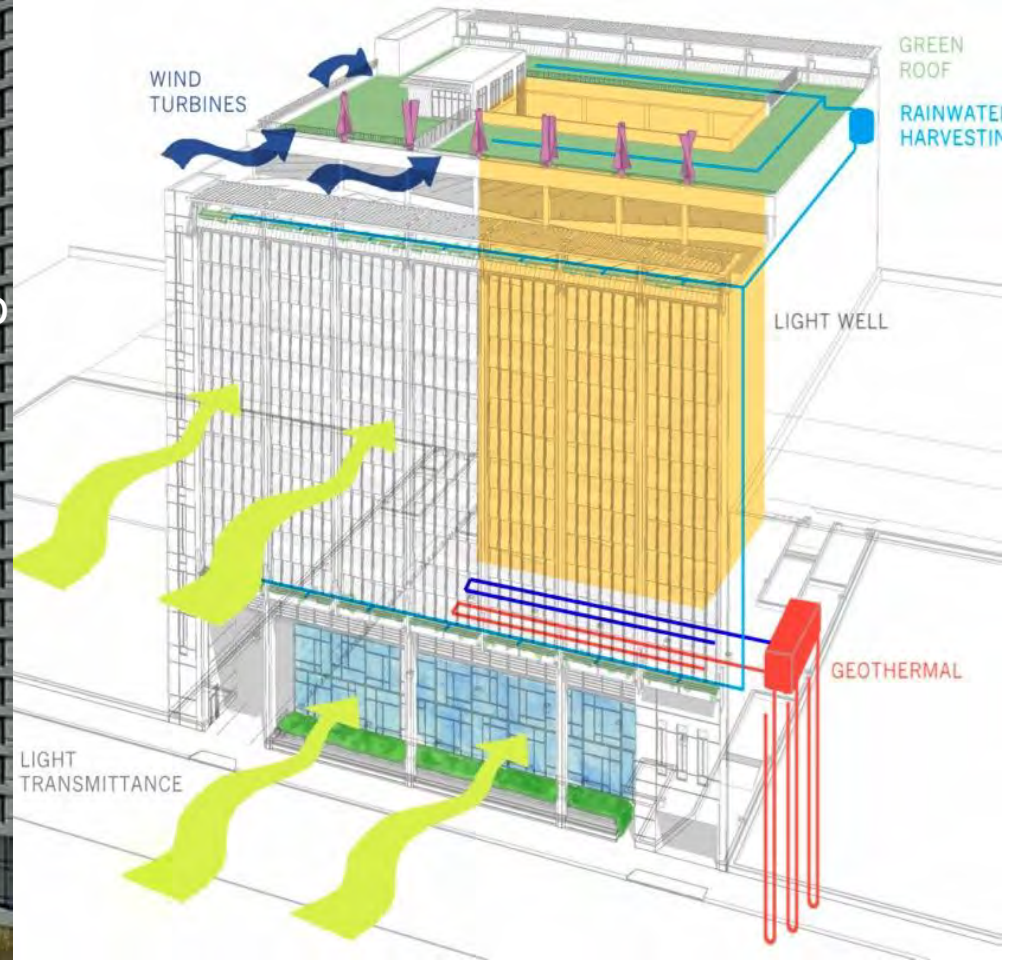

LEED Certified / LEED Silver

Northwestern Grayslake Cancer Center and ASTC



3 stories

300,000 SF

Physician Offices, Outpatient
Surgery & Radiology Imaging
Center and Free-standing ED

Opened October 2004;

Expanded in 2011 and 2013



Destination For Health and Wellness

Northwestern Medicine at the Lake Forest Campus will be a destination for health, wellness and community enjoyment, providing access to the exceptional quality services of the Northwestern Medicine system of care. Through thoughtful design of the campus and its buildings, we will enhance the experience of patients, families and the community.

- 114 acute care beds
- 8 operating rooms
- Outpatient and inpatient diagnostic imaging
- Full *interventional platform* and all ancillary support services
- *Specialty Care* (Cardiology, Cancer, Orthopedics and Neurosciences)
- Site and infrastructure improvements include:
 - ✓ *Central utility plant*
 - ✓ *Parking for 1040 vehicles and roadway improvements*
 - ✓ *Wetlands enhancements, landscape features, and residential buffer treatments*

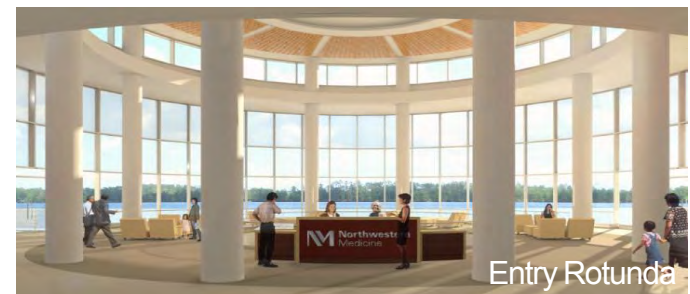

NM Lake Forest Hospital

Site Design

Campus Planning Principles promote wellness, sustainability and sense of place

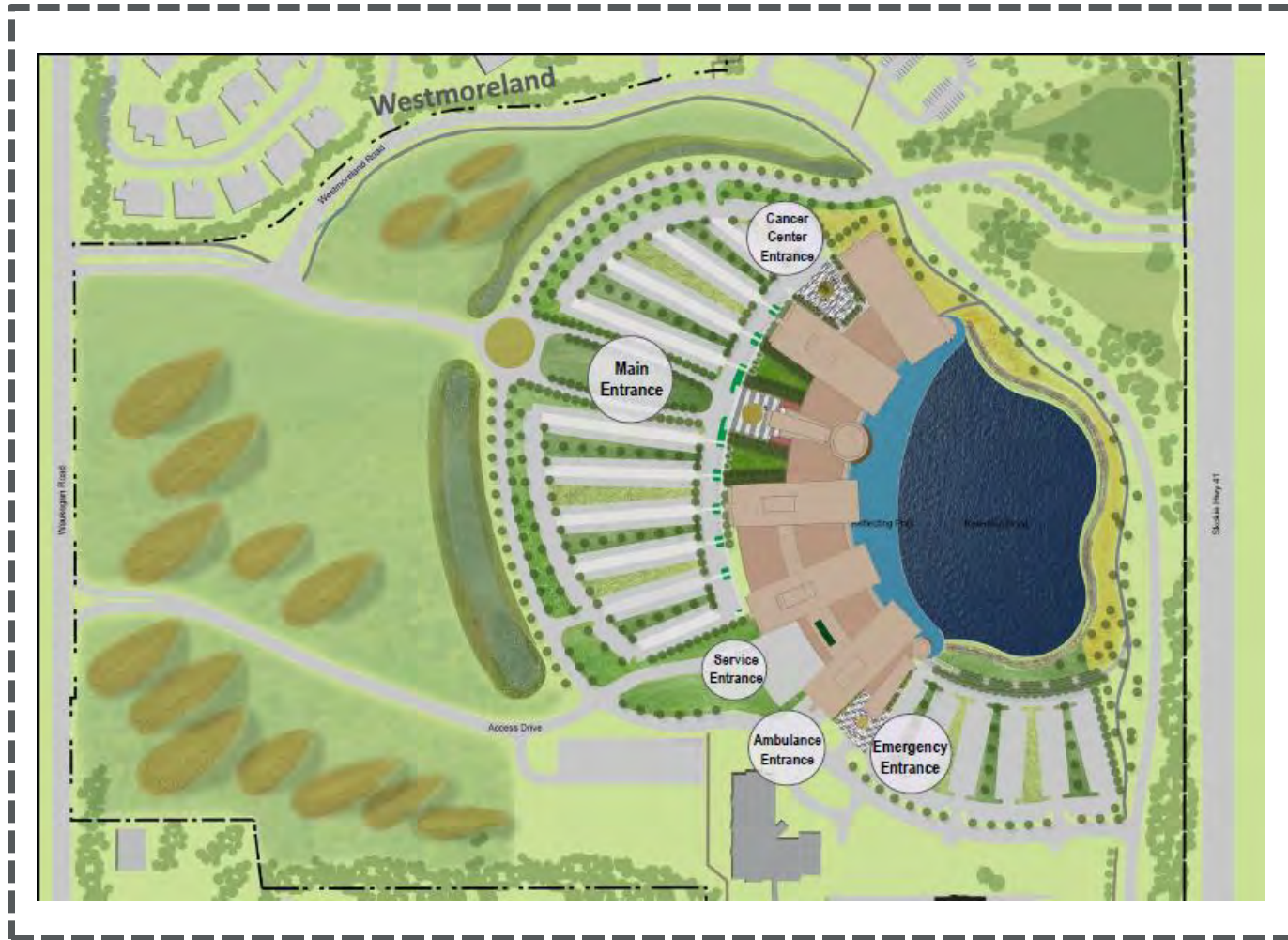

NLFH Central Campus

Campus Landscape Concept

- A. Buffer/Open Prairie B. Wet Meadow / Stormwater Channel C. Ring Road D. Common E. Parking / Bio-swales
F. Building Entry G. Building Courtyard H. Boardwalk I. Weir Wall J. South Promenade K. Pond Edge



NLFH Campus Concept

Campus Landscape Treatment Areas



A. YELLOW CONEFLOWER



B. GREAT BLUE LOBELIA



C. RIVERBANK WILD RYE



D. BOTTLEBRUSH SEDGE



E. INDIAN GRASS

With Standing Water

Without Standing Water



SEED YEAR 1



SEED YEAR 3



PLUGS YEAR 1



PLUGS YEAR 3

Campus Landscape Treatment Areas

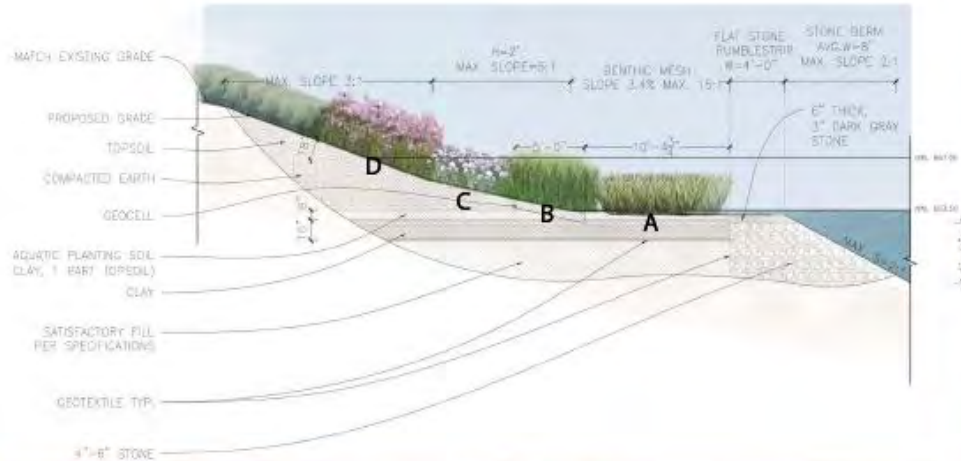

A. SWEET FLAG



B. COMMON RUSH



C. MARSH PHLOX



D. QUEEN OF THE PRAIRIE



SEED YEAR 1



SEED YEAR 3



PLUGS YEAR 1











PLUGS YEAR 3

NLFH Campus Pond's Edge

Campus Landscape Treatment Areas



● Maple	● Hawthorn	● Oak
		
● Redbud	● Birch	● Serviceberry
		
● Hackberry	● Hickory	● Eastern Red Cedar
		



Milestone Schedule

Tracking to Fall 2017 Opening

Task	Target Date(s)	Actual
Mobilization / Start	Jan 26, 2015	Jan 26, 2015
Excavation / Start	February 2, 2015	February 2, 2015
Foundation / Start to 1 st Floor	April 22, 2015	April 15, 2015
Structure / Topping off of each Pavilion	July thru Dec 2015	On Target
Enclosure / Each Pavilion	July thru Dec 2016	On Target
Building Load	April 3, 2017	On Target
Substantial Completion	June 14, 2017	On Target
Opening / First Patient	Fall 2017	On Target

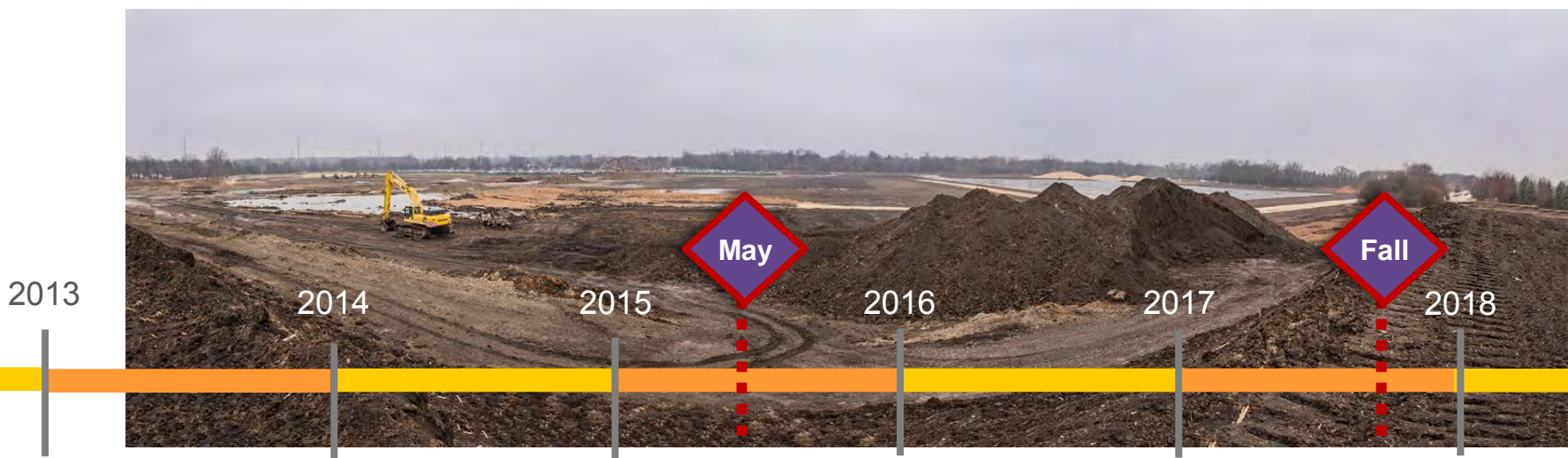



Thank you!

Northwestern Memorial HealthCare
James J. Mladucky AIA, ACHA, CCS
Director Facility Planning & Construction
541 N. Fairbanks Court
Suite 1800
Chicago, Illinois 60611
jmladuck@nm.org